

MANW-LED-600

Construction:

- Steel housing and chassis
- Diffuser UV-stabilized, high impact resistant, DR acrylic

Light Source:

- LED
- Dimming to 10% **Included**

Notes:

- Keyhole slots left and right
- Top and bottom white acrylic lens - standard
- Optional photocell (21) increases fixture depth 1 1/2"
- Optional battery backup
- Optional lens cover (NCL) prevents up/down light
- UL and CUL listed **WET** location
 - Replaceable Module
 - CRI > 90
 - Universal 120/277 volt standard
 - 5-Year Warranty on LED Components
- You may also like the [MERW](#) or [MENW](#) Series

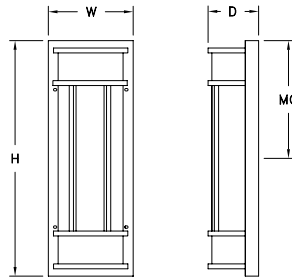

Height - 12" - 16" - 18" - 26" - 38" - 50"
 Width - 6.5"
 Depth - 3.75"

- See 900 or 1100 Series for other width options

Type:	
Job Name:	

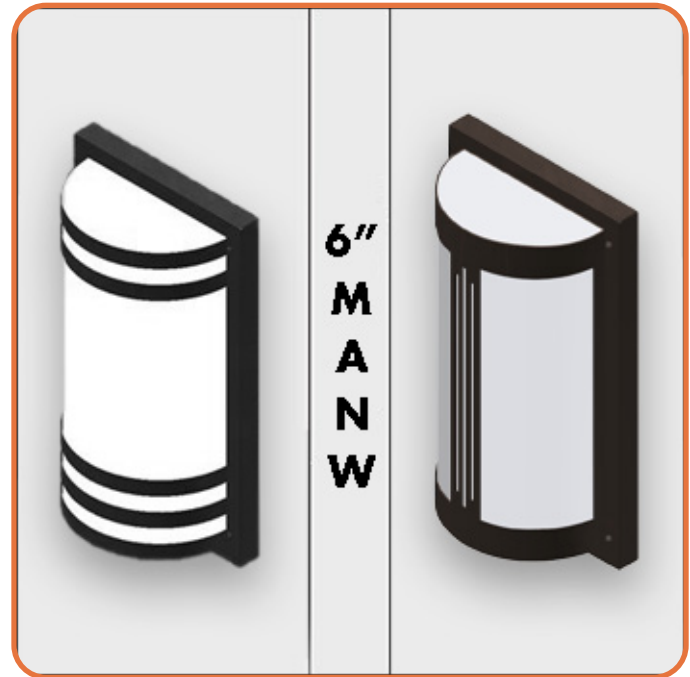

ORDERING INFORMATION

Example: **MANW-616-LED-D-O1C-3-Z1-WSA**

MANW

Size	LED					Kelvin	Cage	Finish	Diffuser	Options
		Watts	Source Lumens	Dimming	Energy Star					
612-LED	F1H	9	1400	0-10v	YES	2 3000K	A	B1 Satin Black	WSA White Smooth Acrylic	DIM LED dimming driver (0 - 10v) DIMLD Line Voltage /TRIAC/ELV/120v Consult Factory 21 Photocell - Specify voltage 01 - 120 volt 02 - 277 volt NCL Lens Cover Top & Bottom ES Energy Star listed components 42 All Aluminum Construction 39 J-Box with knockouts on all sides Battery Backup Options (Available with 0-10v only) BB10 10 Watts (1170lm) for 90-Minutes
	F1P	15	1361	TRIAC/ELV	YES	3 3500K	B	B2 Text Black		
						4 4000K	D	Z1 Satin Bronze		
616-LED	O1C	9	1210	0-10v	NO		C	Z3 Text Bronze		
618-LED	O2A	12	1600	0-10v	NO		E	W1 Yolk White		
626-LED	O2C	18	2420	0-10v	NO		F	W2 Gloss White		
626-LED	F1Y	30	3235	TRIAC/ELV	YES		X	W3 Text White		
638-LED	O3C	27	3630	0-10v	NO			T4 Shimmer Gray		
650-LED	O4C29	29	3412	0-10v	NO			M13 Anod Silver		
	O4C	36	4840	0-10v	NO			T6 Pewter		
								Optional (See Price List) M17 Brass Powder P2 Brushed Alum P9 Brushed Nickel		



28435 Industry Drive., Valencia, California 91355
 800-325-4448 /661-257-0286 • fax 800-323-2346 /661-257-0201
 www.lightwayind.com • sales@lightwayind.com



MANW Series

Cage Styles Options

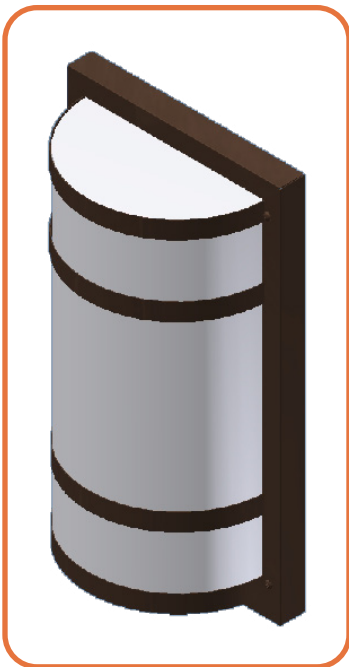

MANW-A

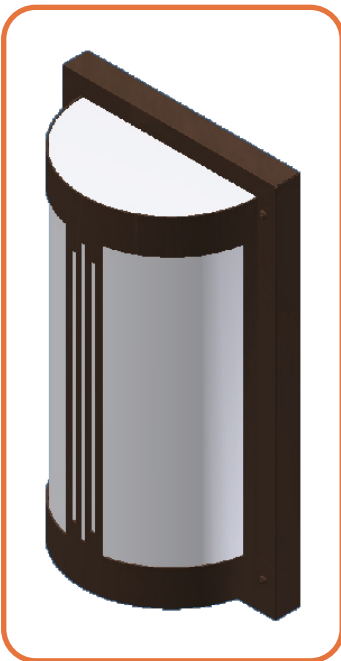

MANW-B

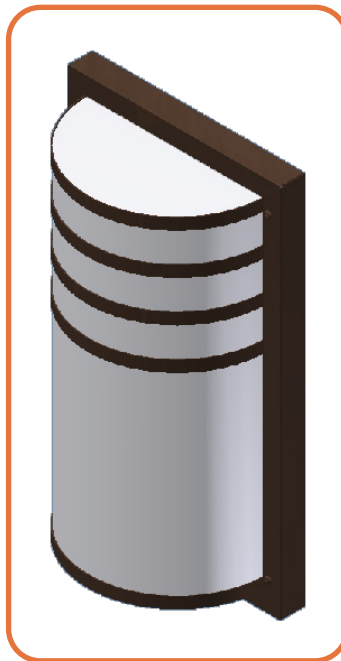

MANW-C

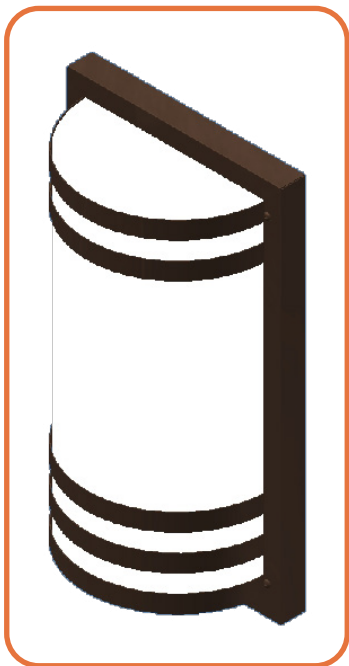

MANW-D

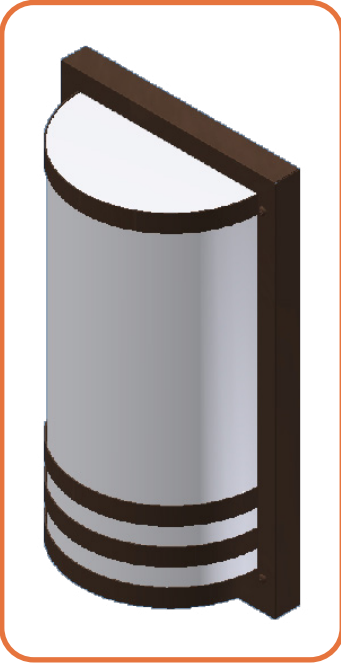

MANW-E

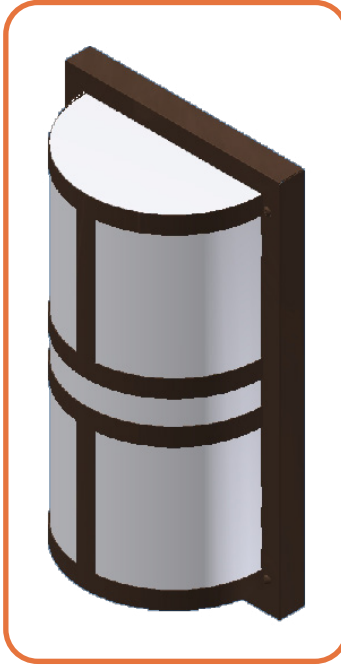

MANW-F



28435 Industry Drive., Valencia, California 91355
West Coast Sales: 800-325-4448 /661-257-0286 • fax 800-323-2346 /661-257-0201
East Coast Sales: 866-350-0991 • fax 866-490-5754
www.lightwayind.com • sales@lightwayind.com

